

SharkBite® Push-Fit Fittings

For Copper, CPVC or PEX Pipe

DESCRIPTION

The SharkBite® push-fit fittings allow the user to connect pipe in seconds with relative ease.

FEATURES AND BENEFITS

Instant push-fit connection for increased ease-of-use:
No soldering, clamps, unions, or glue required.

Fittings certified to 200 PSI and 200°F (93°C):
Proven durability and quality.

Fits copper tubing, and CTS CPVC and PEX:
Connects all three types in any combination.

Integral tube liner for PEX installations:
Integrated design means no loose components, ensures secure, reliable connection.

Design certified and agency listed:
Inspector friendly, peace of mind!

Compact, robust DZR brass body:
Foundation of a strong, corrosion resistant, durable fitting.

Design certified to ANSI/NSF-61 and ASSE 1061 product standard for use in potable water and hydronic heating water distribution:
Quality engineered and manufactured.

Approved to be used underground and behind walls without access panels.

Designed for hydronic heating as well as potable water distribution.

SPECIFICATION

The tube shall be inserted into the **SharkBite® push-fit fitting** in the first stage through a release collar and then through a stainless steel grab ring. The grab ring has teeth that open out and grip onto the tube. At the second stage the tube shall be pushed through an O-ring protector which aligns the tube. A specially formulated EPDM O-ring shall be compressed between the wall of the fitting and the tube before the end of the tube reaches the tube stop. Only when the tube has passed through the O-ring and reached the tube stop shall a secure joint be created. The fitting shall be a **SharkBite® push-fit fitting**.

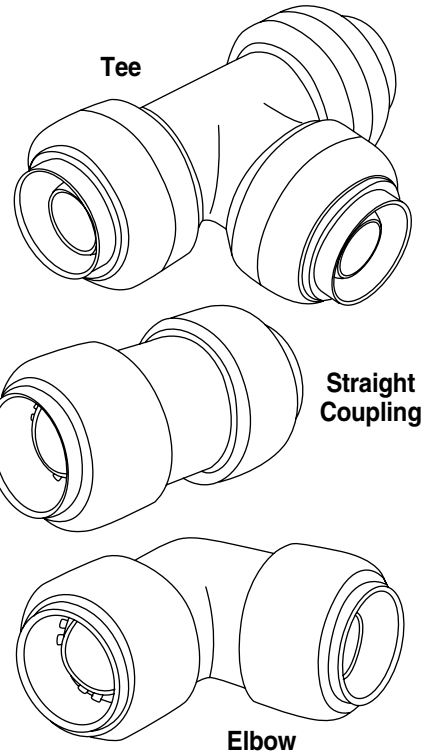

TYPICAL INSTALLATION

Connecting a joint:

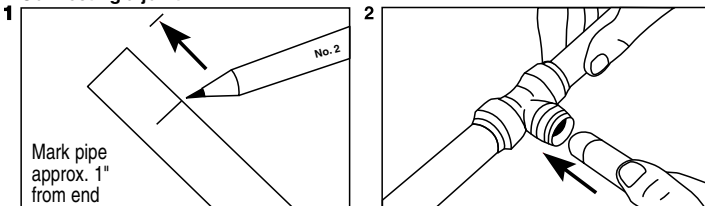

Push the pipe and fitting together firmly with a twisting action until it clicks.
 Allow at least 1" clearance between fittings for disconnection.

(Please consult with local plumbing codes concerning specific water heater piping requirements.)

Disconnecting a joint:

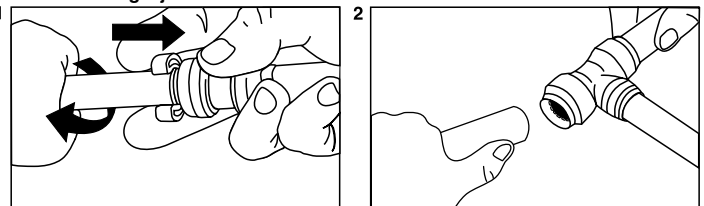

Push the disconnect clip against the release collar and pull the pipe with a twisting action.

SPECIFICATION DATA

Performance:

Maximum working pressure200 psi
 Maximum temperature200°F (93°C)
 ServicePotable water

Materials:

BodyDZR brass
 O-ringEPDM
 Grab ringStainless steel
 Tube support linerPolysulfone

Finish:

Natural Brass or Chrome Plated

CERTIFICATIONS

The **SharkBite® push-fit fittings** have been design certified and listed to **ASSE 1061/NSF 61**. The **SharkBite® push-fit fittings** are listed by **IAPMO** and are certified for potable and hydronic heating water distribution (note: Glycol mixture for hydronics is not to exceed 50% concentration). The **SharkBite® push-fit fittings** have been certified for underground applications and as a manufactured joint without access panels and they meet **UPC, IPC and cUPC** requirements.

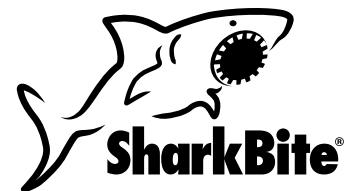

SharkBite® Push-Fit Fittings

For Copper, CPVC or PEX Pipe

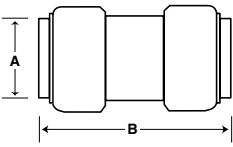

Straight Coupling Dimensions

P/N	A	B
U004	1/4"	1.59"
U006	3/8"	1.84"
U008	1/2"	2"
U016	3/4"	2.36"
U020	1"	2.72"

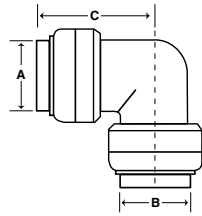

Elbow Dimensions

P/N	A	B	C
U244	1/4"	1/4"	1.16"
U276	1/4"	3/8" MIP	1.16"
U246	3/8"	3/8"	1.28"
U272	1/2"	3/8"	1.43"
U248	1/2"	1/2"	1.36"
U256	3/4"	3/4"	1.64"
U260	1"	1"	1.933"
U274	3/4"	1/2"	1.373"
U280	1/2"	1/2" MNPT	1.21"
U308	1/2"	1/2" FNPT	1.21"

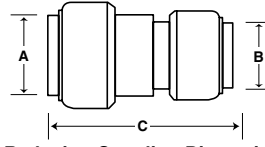

Reducing Coupling Dimensions

P/N	A	B	C
U009	3/8"	1/2"	2.0"
U058	3/4"	1/2"	2.2"
U060	1"	3/4"	2.51"

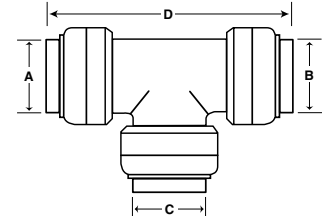

Tee Dimensions

P/N	A	B	C	D
U358	1/4"	1/4"	1/4"	2.30"
U360	3/8"	3/8"	3/8"	2.77"
U362	1/2"	1/2"	1/2"	2.72"
U363	1/2"	1/2"	3/8"	2.85"
U364	3/8"	3/8"	1/2"	2.77"
U370	3/4"	3/4"	3/4"	3.24"
U374	1"	1"	1"	3.84"
U412	3/4"	3/4"	1/2"	3.04"
U416	1"	1"	3/4"	3.63"
U444	3/4"	1/2"	3/4"	3.08"
U454	3/4"	1/2"	1/2"	2.92"

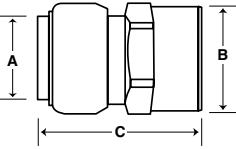

Connector Dimensions

P/N	A	B	C
U066	1/4"	1/2" FNPT	1.61"
U068	1/2"	3/4" FNPT	1.75"
U070	3/8"	1/2" FNPT	1.73"
U072	1/2"	1/2" FNPT	1.64"
U092	3/4"	1/2" FNPT	1.83"
U088	3/4"	3/4" FNPT	1.88"
U094	1"	1" FNPT	2.17"
U110	1/4"	1/2" MNPT	1.64"
U118	3/8"	1/2" MNPT	1.77"
U120	1/2"	1/2" MNPT	1.64"
U116	1/2"	3/4" MNPT	1.75"
U134	3/4"	3/4" MNPT	1.89"
U138	3/4"	1/2" MNPT	1.90"
U140	1"	1" MNPT	2.48"
U142	1"	3/4" MNPT	2.11"

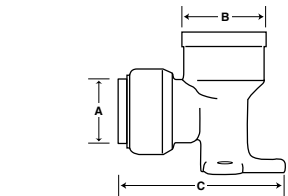

Drop Ear Elbow Dimensions

P/N	A	B	C
U249	1/2"	1/2"	2.20"
U332	3/8"	1/2" FNPT	1.83"
U334	1/2"	1/2" FNPT	1.77"
U335*	1/2"	1/2" FNPT	2.0"
U340	3/4"	3/4" FNPT	2.5"

*Hy-Ear Elbow

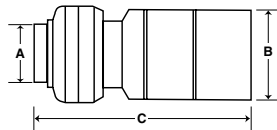

Fitting Reducer Dimensions

P/N	A	B	C
U719	3/8"	1/2"	2.08"
U721	3/8"	3/4"	2.27"
U722	1/2"	1"	3"
U724	3/4"	1"	2.5"

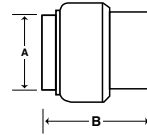

End Stop Dimensions

P/N	A	B
U512	3/8"	1.11"
U514	1/2"	1.08"
U518	3/4"	1.32"
U520	1"	1.52"

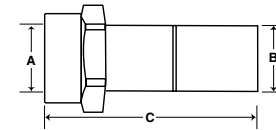

Fitting Adapter Dimensions

P/N	A	B	C
U766	3/4" FNPT	3/4"	2.83"
U772	1" FNPT	1"	2.83"

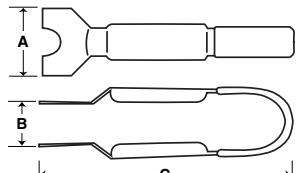

Disconnect Tong Dimensions

P/N	Fits SharkBite	A	B	C
U711	1/2"	1.7"	2"	6.5"
U713	3/4"	1.7"	2"	6.5"
U715	1"	1.7"	2"	6.5"

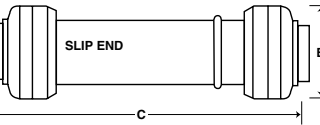

Slip Coupling* Dimensions

P/N	A	B	C
U3008	1/2"	1.075"	4.46"
U3016	3/4"	1.355"	4.42"
U3020	1"	1.64"	4.5"

*For use with copper only.

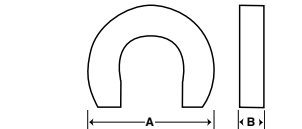

Disconnect Clip Dimensions

P/N	Size	A	B
U706	1/4"	1.19"	0.3"
U708	3/8"	1.22"	0.3"
U710	1/2"	1.22"	0.3"
U712	3/4"	1.72"	0.4"
U714	1"	2"	0.4"

Note: Disconnect Clips sold separately

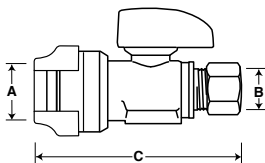

Straight Stop (Chrome Plated) Dimensions

P/N	A	B	C
23037-0000	1/2"	3/8" compression	2.68"

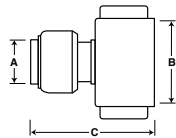

Ballcock Connector Dimensions (Chrome Plated)

P/N	A	B	C
U3531	1/4"	7/8" ballcock	1.58"

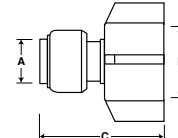

Faucet Connector Dimensions (Chrome Plated)

P/N	A	B	C
U3525	1/4"	1/2" NPS	1.58"

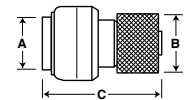

Stop Connector Dimensions (Chrome Plated)

P/N	A	B	C
U3523	1/4"	9/16" X 24 UNEF	1.61"

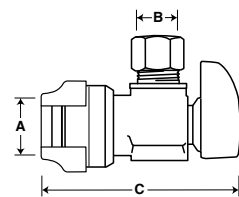

Angle Stop (Chrome Plated) Dimensions

P/N	A	B	C
23036-0000	1/2"	3/8" compression	2.58"

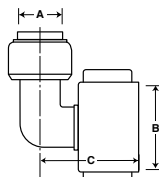

Ballcock Elbow Dimensions (Chrome Plated)

P/N	A	B	C
U3537	1/4"	7/8" ballcock	1.05"